



With reference to the proposed disposal of a further licence of Units T02-T07 and T22 of the Markets Area Community Resource Organisation (MACRO) Building, Green Street/North King Street, Dublin 7.

By way of licence dated 4th February 2016, Units T02-T07 and T22 of the Markets Area Community Resource Organisation (MACRO) Building, Green Street/North King Street, Dublin 7 which is delineated on Map Index No. SM2010-0692-001 was let under licence by Dublin City Council to the European Consumer Centre (Ireland) Limited for a period of 2 years commencing on 1st November 2015. This licence is due to expire on 31st October 2017.

It is proposed to grant a further two year licence to the European Consumer Centre (Ireland) Limited subject to the following terms and conditions:

1. The proposed licence shall be for the period of 2 years from 1st November 2017 subject to a licence fee of €1.00 if demanded.
2. The proposed licensed area is Unit T02 – T07 and Unit T22, and is more particularly shown coloured pink on Map Index No. SM2012-0692-001.
3. The proposed licence shall be subject to a contribution fee of €21,420 per annum in respect of the cost of managing the building, payable quarterly in advance directly to MACRO Building Management CLG.
4. The licensee shall sign a deed of renunciation in respect of the licensed area.
5. The licensee shall be entitled to use the licensed area for office use only during the opening hours of the Markets Area Community Resource Organisation building which are 8.00 am to 10.00pm daily.
6. The licence can be terminated by either party on giving the other one months notice in writing.
7. The licensee shall be responsible for all outgoing including waste charges and any water charges which may become payable.
8. The licensee shall keep its part of the premises in good condition and repair during the term of the licence.
9. The licensee shall obtain public liability insurance (€6.5 million) and employer's liability insurance (€13 million) if they have employees and shall indemnify the City Council against any and all claims for compensation, which may arise from their use of their use of the property.
10. On termination of the licence, the licensee shall be responsible for the removal of all their materials from the premises

11. The licensee shall not assign, sub-let, alienate or part with possession of the subject property.
12. The licensee shall not erect any signage on the external or internal walls of the subject property without the prior consent of the Council.
13. The licence will be subject to any terms and conditions deemed appropriate by the Council's Law Agent.
14. Each party shall be responsible for its own legal costs.

The area proposed to be licensed is contained in the MACRO Building which is built on lands which form part of the Council's City Estate (Reference AR 208).

The proposed disposal shall be subject to such conditions as to title to be furnished as the Law Agent in his discretion shall stipulate.

No agreement enforceable at law is created or intended to be created until an exchange of contracts has taken place.

This proposal was approved by the Central Area Committee at its meeting on the 13th June 2017.

This report is submitted in accordance with the requirement of Section 183 of the Local Government Act 2001.

Dated this the 16th day of June 2017.

Paul Clegg
Executive Manager

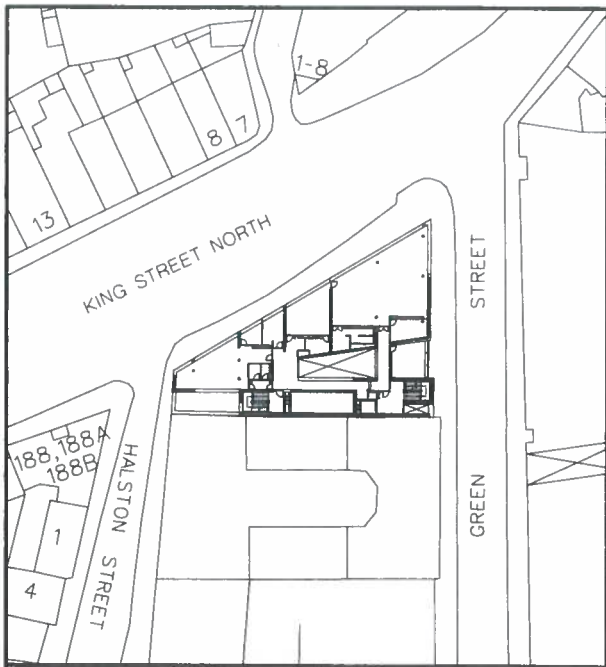

SITE PLAN (SCALE 1:1000)

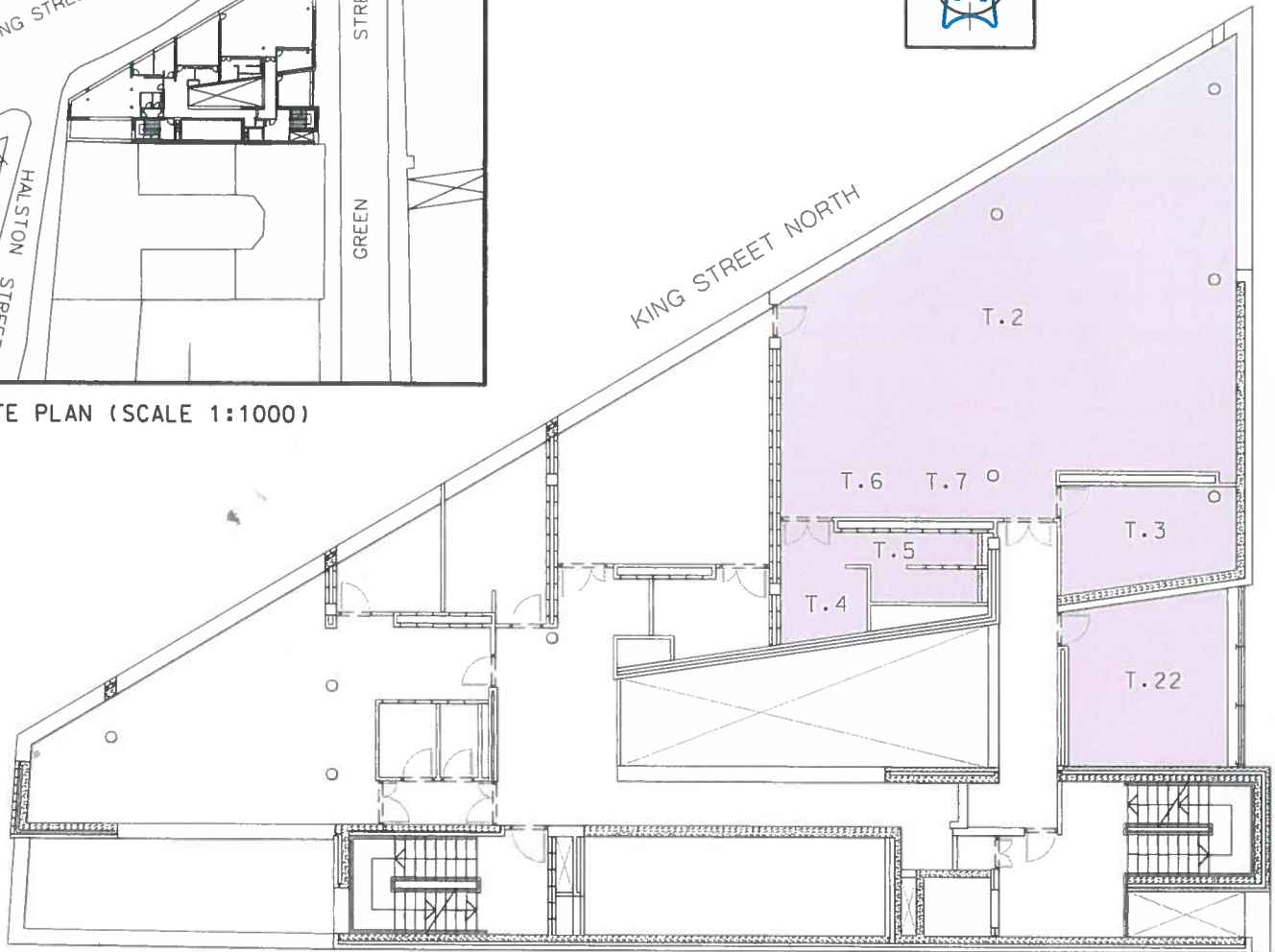
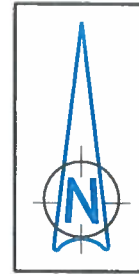

THIRD FLOOR PLAN (SCALE 1:200)

HALSTON STREET /NORTH KING STREET /GREEN STREET – MACRO BUILDING
Rooms T.02, T.03, T.04, T.05, T.06, T.07, T.22 (AREA: 161.5 sq m)
Dublin City Council to European Consumer Centre (Ireland) Limited
DISPOSAL OF LICENCE



DUBLIN CITY COUNCIL

Comhairle Cathrach Bhaile Átha Cliath
ENVIRONMENT AND ENGINEERING DEPARTMENT
An Roinn Comshaoil agus Innealtóireachta
SURVEY AND MAPPING SERVICES DIVISION
Rannán Seirbhísi Suirbhéireachta agus Léarscailithe

O.S REF 3263-04, 3263-05	SCALE 1:1000 / 1:200
DATE 18.11.2010 REV: 09.08.2011 REV: 08.02.2013	SURVEYED / PRODUCED BY TJC

INDEX No	FOLDER No	CODE	DWG No	REV
FILE NO SM-2010-0692-0204- C3 - 001 - B.dgn				

FOR PROPERTY REGISTRATION AUTHORITY PURPOSES ONLY
 THIS MAP IS CERTIFIED TO BE COMPUTER GENERATED BY
 DUBLIN CITY COUNCIL FROM ORDNANCE SURVEY DIGITAL MAPBASE

MICHAEL PHILLIPS
CITY ENGINEER

SIGNED _____
PATRICK SHINE
 MANAGER LAND SURVEYING & MAPPING
 DUBLIN CITY COUNCIL

INDEX No.
SM-2010-0692-001